

活塞式和螺杆式压缩机工作过程中，压力的脉冲会进入排气管。通过连接的管路，脉冲振动会引起系统的噪音和震动，严重的会导致管道破裂。为了减少这些脉冲震动，建议在压缩机排气管上安装消声器。

- 安装在避震软管的后面；
- 设计压力：2.9MPa；
- 适用制冷剂：R134a、R22、R407C、R404A、R507A。

The pressure pulse will enter into the discharge line during the running process of the piston compressor and the screw compressor. The pulse will cause the system to shock and have noises through the connected lines, and even more serious it will damage the lines. In order to decrease the pulse shocking, it is recommended to install the discharge line muffler in discharge line of the compressor.

- To be installed next to the shock-proof hose;
- The design pressure: 2.9MPa;
- Applicative refrigerants: R134a、R22、R407C、R404A、R507A.

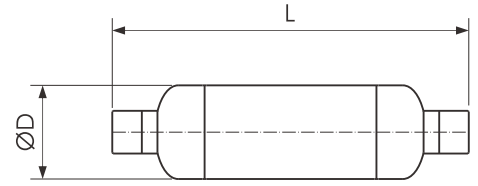

a

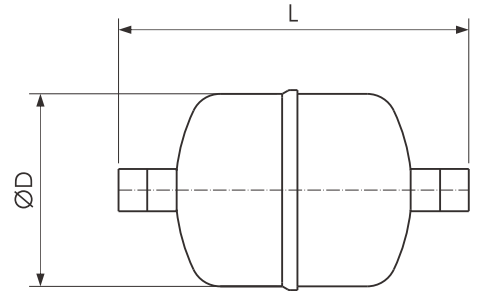

b

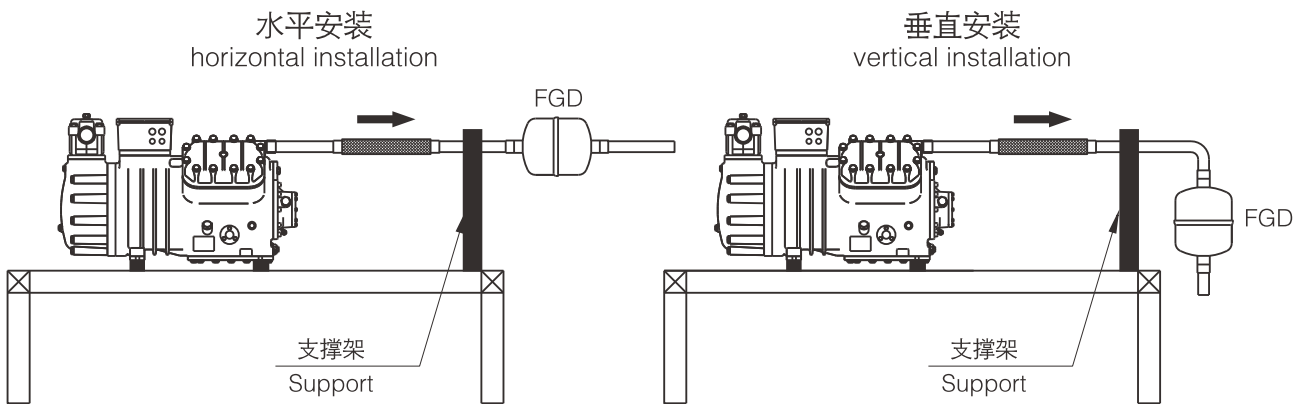

型号 Model	接口尺寸 Joint Size(Inch)	压缩机理论排气量 Theo.Compressor Displacement	ØD (mm)	L (mm)	容积 Volume(l)	图例 Fig.
FGD-05	5/8"	23	57	207	0.3	a
FGD-06	3/4"	30	57	205	0.3	a
FGDS-07	7/8"	42	57	217	0.3	a
FGD-07	7/8"	42	127	196	1.1	b
FGD-09	1-1/8"	74	127	212	1.1	b
FGDS-11	1-3/8"	110	127	222	1.1	b
FGD-11	1-3/8"	110	127	344	2.3	b
FGDS-13	1-5/8"	170	127	232	1.1	b
FGD-13	1-5/8"	170	127	353	2.6	b
FGDS-17	2-1/8"	290	127	246	1.1	b
FGD-17	2-1/8"	290	127	490	3.9	b